

# Entry-Level Stereo Zoom Microscopes

Stereo microscopes for macro-sized specimens, ideal for college students

## Unique Features:

### VIEWING HEAD

- Binoc/Trinocular viewing head with 45° angle
- Interpupillary adjustment 52mm to 75mm
- Diopter adjustment
- Auxillary lenses/Camera options available

### PRESETS

- Transmitted only
- Reflected only
- Discopic only
- Darkfield only
- Reflected and Transmitted
- All on (DF, DI, REFL, TRANS)

### FOCUSING

- 70mm working distance
- 40mm height adjustment on focusing mechanism
- Coarse focus adjustment

### OPTICAL SYSTEM

- 10X WF eyepieces
- Continuous zoom control
- 1X - 4X objective
- Zoom ratio 1 : 4

### ILLUMINATION

- LED ring in transmitted light provides homogeneous light distribution
- LED incident illumination
- Eco-friendly and energy-efficient LED illumination
- Membrane switch controls
- LED light indicator on membrane switch identifies which lighting technique is turned on

### STAND

- Low-profile, plain stage with clips
- Large, flat base to accommodate larger samples
- Compact design



## Specifications

Hardware	Descriptions
Viewing Head	Stereo Binocular Viewing Head, Inclined at 45°. (03-000-018, 03-000-019, 03-000-020, 03-000-039)
	Stereo Trinocular Viewing Head, Inclined at 45°. (03-000-021, 03-000-022, 03-000-023, 03-000-028)
Interpupillary Distance	52mm - 76mm
Eyepiece	WF 10X
Zoom Objective	1X - 4X
Zoom Ratio	1 : 4
Auxillary Objective	2X
Working Distance	70mm
Stand	Post Stand with Illumination (03-000-018, 03-000-021, 03-000-039, 03-000-028)
	No Illumination (03-000-019, 03-000-022)
	Boom Stand No Illumination (03-000-020, 03-000-023)
Stage Plate	(03-000-018, 03-000-021, 03-000-039, 03-000-028)
Illumination	LED Incident Illumination, LED Transmitted Illumination (03-000-018, 03-000-021, 030-00-039, 03-000-028)
C-mount	0.5X (03-000-028)
Camera	3MP Color (03-000-028)
Dimension	W 22 x D 32.9 x H 36cm

## Ordering Information

Product	Cat. No.
Binocular Head, Objective, Low Profile Stand, Transmitted/Reflected Illumination	03-000-018
Binocular Head, Low Profile Plain Stand, No Illumination	03-000-019
Binocular Head, Boom stand No Illumination	03-000-020
Trinocular Head, Low Profile LED Stand, Transmitted/Reflected	03-000-021
Stereo Trinocular Head, Low Profile Stand, No Illumination	03-000-022
Trinocular Head, Boom Stand, No Illumination	03-000-023
Binocular Head, Low Profile LED Stand, Transmitted/Reflected	03-000-039
Trinocular Head, Low Profile LED Stand, Transmitted/Reflected, 0.5X C-mount, 3MP Color Camera	03-000-028

## Magnification Chart

Model	Magnification
10X eyepiece with 1X/3X	10X, 30X
10X eyepiece with 2X/4X	20X, 40X
5X eyepiece with 1X/3X	15X, 30X
15X eyepieces with 2X/4X	30X, 60X

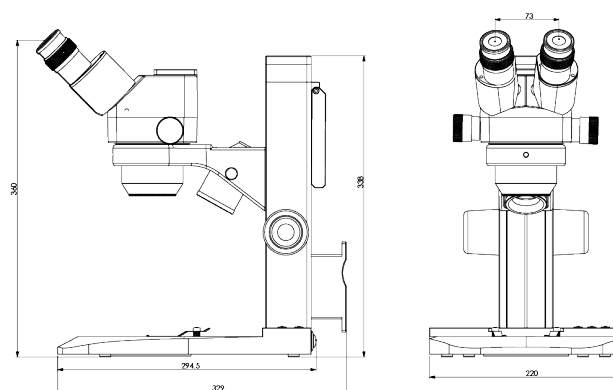

Measurements are in mm, overall dimension may change slightly depending on model

Find out more at [fishersci.com](http://fishersci.com)

### In the United States:

For customer service, call 1-800-766-7000

To fax an order, use 1-800-926-1166

To order online: [fishersci.com](http://fishersci.com)

### In Canada:

For customer service, call 1-800-234-7437

To fax an order, use 1-800-463-2996

To order online: [fishersci.ca](http://fishersci.ca)

